

INTERIOR LIGHT REMOVAL/INSTALLATION

B3E091801058W03

1. Disconnect the negative battery cable.
2. Insert a tape-wrapped flathead screwdriver into the service hole and pry with the screwdriver in the direction shown by the arrow to remove the lens.

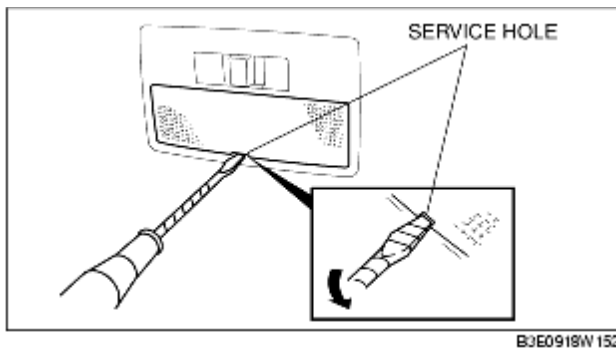

3. Insert a tape-wrapped flathead screwdriver into the gap between the headliner and the interior light.

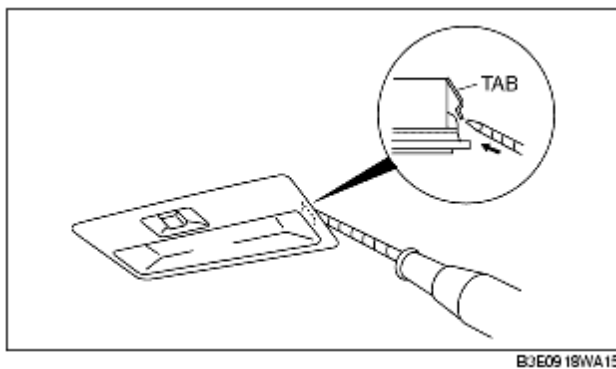

4. Press the tab and remove the interior light.

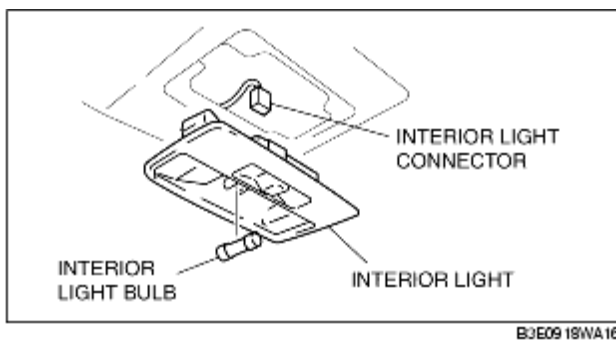

5. Disconnect the interior light connector.
6. Install in the reverse order of removal.